

## General

---

### Minimum order quantity

1

### Warranty

Separate sheet

### Return policy

Order cancellation permitted before product ships subject to \$75-100 re-stocking fee per product

Once product ships no returns unless covered by warranty (due to custom nature of the tables)

### Materials

EPP - expanded polypropylene

### Code

Xbrick/

### Surface load capacity

up to 440 lbs

### Cleaning

Sterilizable

Easy to clean with mild soap and water and a soft cloth or sponge

### Recyclability

100% recyclable

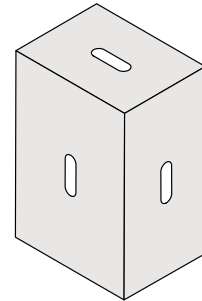

## Dimensions

---

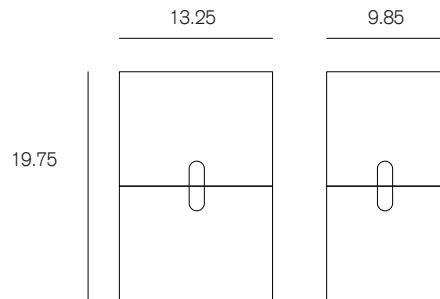

Weight: 3 lbs

## Finishes

---

Color

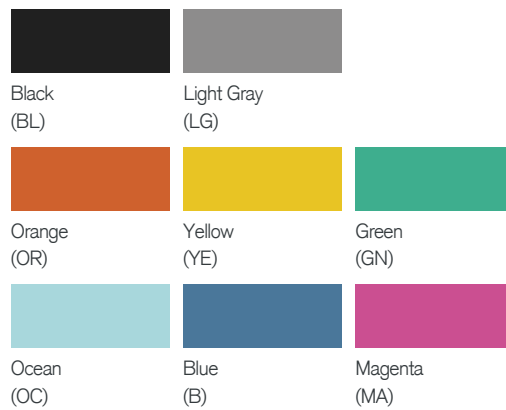

How to combine

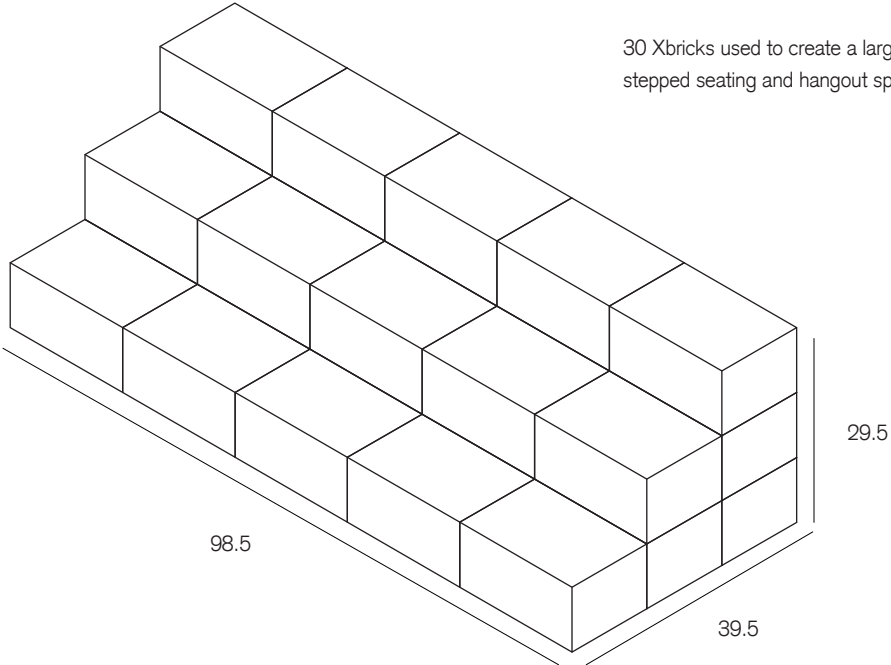
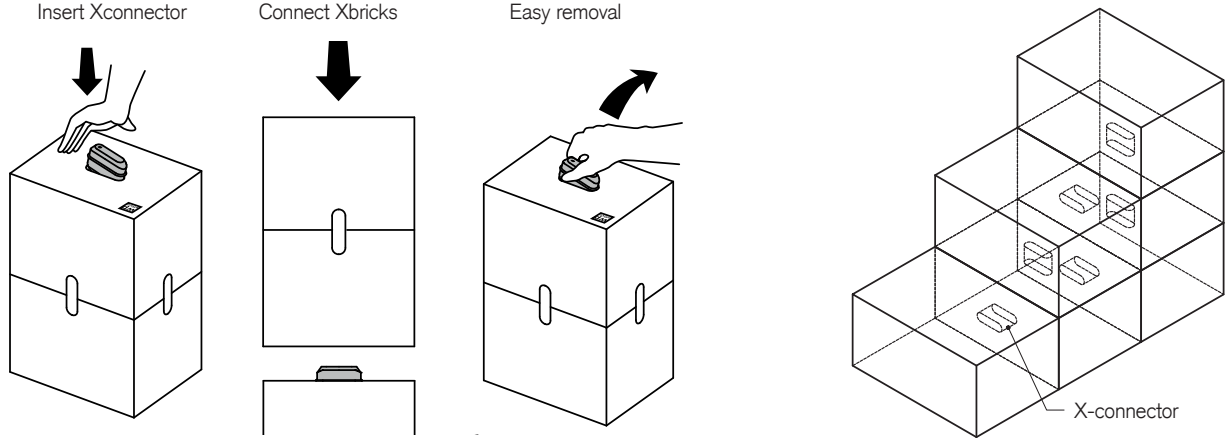

## Add ons to make Xbench and Xtable

---

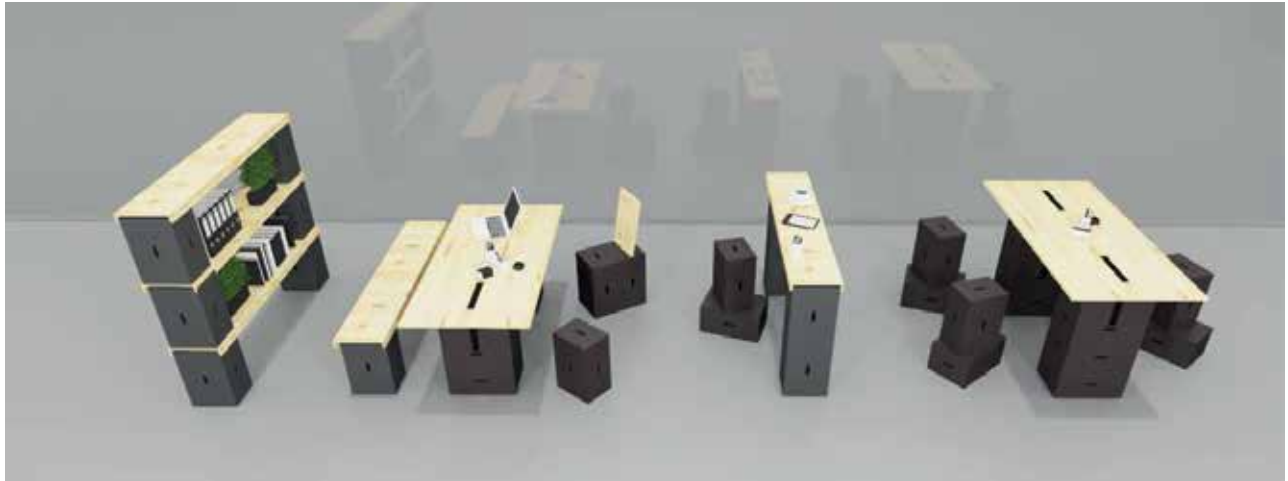

Xtable  
Combine wooden top specially designed to be supported by Xbricks strapped together to create a table.



Xbench  
Combine wooden top specially designed to be supported by Xbricks to create a robust bench.

Contact info

---

Inquiries

hello@muzo-works.com

Purchase orders

sales@muzo-works.com

360 Kiwanis Blvd,  
West Hazleton, PA 18202

(800) 670-2578

muzo-works.com