

muzo

Block (table)

General

Uses

Terraces, Canteens, Breakout areas

Warranty

10 years

Return policy

Full payment will still be required for orders cancelled after 7 days.

Materials

Frame: Powder-coated aluminum legs
Surface: Solid wood (bespoke available)

Code

BLOCK/S2/ 2 seater table
BLOCK/S4/ 4 seater table
BLOCK/S6/ 6 seater table
BLOCK/S8/ 8 seater table

Options

Bolt-down brackets
Outside and Inside use
Non-standard RAL colors

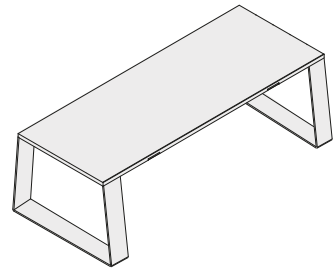

Product dimensions

Product type	Height	Width	Table depth	Overall Depth	Weight
BLOCK/S2/	29.5"	35.5"	27.5"	34.5"	60 lbs
BLOCK/S4/	29.5"	59"	27.5"	34.5"	82 lbs
BLOCK/S6/	29.5"	79"	27.5"	34.5"	100 lbs
BLOCK/S8/	29.5"	90.5"	27.5"	34.5"	111 lbs

muzo

Block (bench)

General

Uses

Terraces, Canteens, Breakout areas

Warranty

10 years

Return policy

Order cancellation permitted before product ships subject to \$75-100 re-stocking fee per product

Materials

Frame: Powder-coated aluminum legs
Surface: Solid wood (bespoke available)

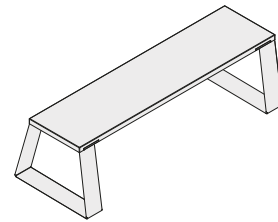

Code

BLOCK/B/S1/ 1 seater bench
BLOCK/B/S2/ 2 seater bench
BLOCK/B/S3/ 3 seater bench
BLOCK/B/S4/ 4 seater bench

Options

Bolt-down brackets
Outside and Inside use
Non-standard RAL colors

Product dimensions

Product type	Height	Width	Bench depth	Overall Depth	Weight
BLOCK/B/S1/	18"	20"	12"	16"	22 lbs
BLOCK/B/S2/	18"	44"	12"	16"	31 lbs
BLOCK/B/S3/	18"	63"	12"	16"	40 lbs
BLOCK/B/S4/	18"	75"	12"	16"	44 lbs

muzo

Block (end bench)

General

Uses

Terraces, Canteens, Breakout areas

Warranty

10 years

Return policy

Order cancellation permitted before product ships subject to \$75-100 re-stocking fee per product

Materials

Body: Powder-coated aluminum

Code

BLOCK/EB/S1/ 1 seater bench
BLOCK/EB/S2/ 2 seater bench
BLOCK/EB/S3/ 3 seater bench
BLOCK/EB/S4/ 4 seater bench

Options

Bolt-down brackets
Outside and Inside use
Non-standard RAL colors
Cushions

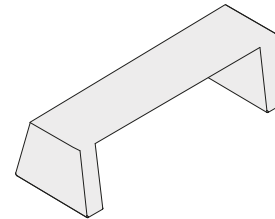

Product dimensions

Product type	Height	Width	Bench depth	Overall Depth	Weight
BLOCK/EB/S1/	18"	20"	12"	17"	18 lbs
BLOCK/EB/S2/	18"	44"	12"	17"	27 lbs
BLOCK/EB/S3/	18"	63"	12"	17"	31 lbs
BLOCK/EB/S4/	18"	75"	12"	17"	36 lbs

Finishes

Outside



Solid Iroko
Unfinished - will turn silver gray when exposed to UV light

Inside
FSC birch ply
Tinted lacquer

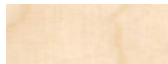

Clear lacquer



Light Pink



Light Blue

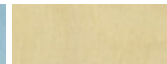

Light Ivory



Traffic Red



Black

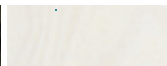

Cream



Green



Laminate on ply

Frame
Powder coat



BS 02 C 33



RAL 6028



BS 18-C-35



RAL 1015



RAL 3020



RAL 9004



RAL 9001

Special colors
(upcharge applies)



BS 12-E-51



RAL 2005



RAL 1007



RAL 1016



RAL 5026

Packaging information

Packaging varies according to the nature of the order size, this means we use packaging in the most effective and eco-friendly way.

Contact info

Inquiries

hello@muzo-works.com

Purchase orders

sales@muzo-works.com

360 Kiwanis Blvd,
West Hazleton, PA 18202

(800) 670-2578

muzo-works.com